

## Cartridge Replacement/Maintenance Steps:

1. Remove all decorative trim to gain access to front of the valve.
2. Shut off the water inlets by tightening the two screws at the two check stop valves (5).
3. Pull off the temperature limit-ring (4) from the thermostatic valve.
4. Unscrew the thermostatic cartridge (2) with a 24mm socket wrench or an adjustable wrench in a counter-clockwise direction and gently pull it out.
 

NOTE: For TH2000 and TH4000, use a 17mm socket wrench or an adjustable wrench to remove the volume control cartridge (3).
5. If you're cleaning the thermostatic cartridge (2) for re-installation:
 

\*(NOTE: It's also advisable to clean the check valves (6) at the same time)

  - A. Clean the screens and rinse with water.
  - B. If necessary, soak in 50/50 mix of white vinegar/water or a de-scaling agent until all the dirt is dissolved.
  - C. Grease the o-rings with a silicone based grease and wipe the housing with a wet cloth.
6. Screw new or recently cleaned cartridge(s) into the main valve body (1) using a wrench in the clockwise direction. Make sure the red dot on the temperature limit-ring is aligned in the 12 o'clock position.
7. Turn the water back on and test the valve before re-installing decorative trim.

NOTE: To prevent the handle from accumulating mineral build up, which can cause it to "lock up", the handle must be turned on an occasional basis.

### \*CHECK VALVE REMOVAL:

- A. Shut off water lines going into the valve inlets.
- B. Unscrew the check stop valve (5) using a 26mm socket wrench or an adjustable wrench in a counter-clockwise direction.
- C. Remove check valve (6) using needle-nose pliers being careful not to damage the surface.

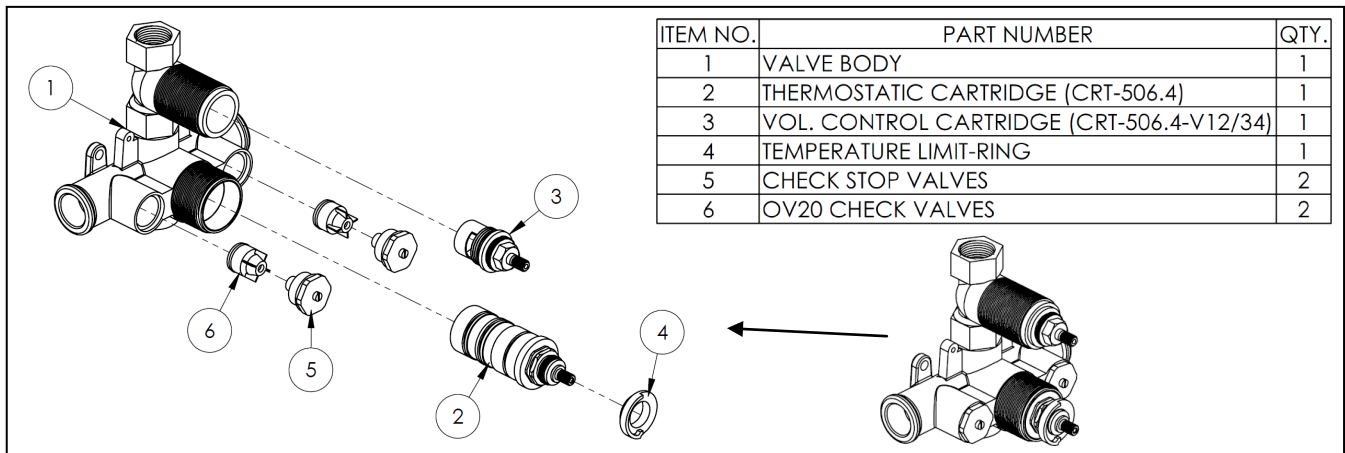

### RETURN POLICY

All cartridges are shipped in a clear plastic bag, so you can examine it carefully upon receipt. If the part is not correct, you can return it for a full refund less freight as long as the bag is unopened. Once the bag is opened, the cartridge can only be returned for credit if deemed defective and is accompanied with original proof of purchase (not the replacement order.)

**For technical support, please call 718-257-2800**